



DUFOUR | 40

September 2004

Naval architect	Umberto Felci	
Deck and interior design	Patrick Roséo	
Length overall	m	12,32
Hull length *	m	12,06
Waterline length	m	10,74
Max beam *	m	3,9
Waterline beam	m	3,18
Draft (shoal keel – deep keel)	m	1,65 – 2,10
Keel height (shoal keel – deep keel)	m	1,12 – 1,56
Keel weight (shoal keel – deep keel)	kg	2815 – 2690
Keel material (shoal keel – deep keel)	Cast iron-lead	
Light displacement with moorings	kg	7800-7900
Genoa area	m ²	40,75
Mainsail area	m ²	41,6
Asymmetric spinnaker area	m ²	89
Symmetric spinnaker area	m ²	104
Icebox volume	L	90
Water tank	L	330
Water heater capacity	L	20
Fuel tank	L	160
Service battery	Ah	100
Engine battery	Ah	100
Max engine power Volvo 2030 (kW)	kW	29,1
Air draft (incl nav light but excl antenna)	m	17,65
Boat height with pulpit (without mast)	m	3,7-4,2
Overall height: mast top - keel bottom	m	19,3-19,8
Mast length (incl nav light, excl antenna)	m	16,0-16,53
I (long mast)	14,66(15,25)	
J	4,19	
P (long mast)	14,25(14,75)	
E	5,25	
LP (140%)	5,86	
SL	14,48	
SMW	7,542	

* official measurement



DUFOUR YACHTS

LA ROCHELLE

CONSTRUCTION

Hand laminated GRP Hull, vacuum bagged PVC foam core sandwich above water line.

NPG Gelcoat with first layer of cloth impregnated with NPG resin forming an optimum barrier against osmosis.

Inner moulded hull bottom, **structural framing laminated to the hull.** Navy blue decorative stripes on hull and coach roof.

Provision for ducting (heating or conditioning). **Deck in PVC foam core sandwich, moulded by injection process (Resin Transfer Moulding)** for significant weight saving and excellent interior finish. Standard draft 1.60 m, cast iron keel, bolts loads taken up by stainless steel backing plate. Semi-elliptical **rudder**, filled with closed cell epoxy foam. Stainless steel solid stock, **on self-aligning bearings.**

DECK & DECK FITTINGS

Teak handrails on coachroof. **Wood toerail on hull-deck joint.** Self-draining chain locker with eye bolt and laminated windlass bracket, cover with locking bolt. Stemhead fitting with removable anchor roller. **Pulpit in two separate parts** with separate green/red navigation lights.

Asymmetrical spinnaker tack ring ahead of forestay. Pushpits with horseshoe buoy bracket, flag pole holder and opening cable gate with hook. Stanchions with 2 levels of stainless steel guard-rails. 6 Mooring cleats on backing plates, stainless steel rubbing plates on sheer line. Single chainplate for cap shrouds/aft lower shrouds including an eye for fixing extra control lines. 2 deck filler plates for water, 1 for fuel.

Mainsheet track on cockpit sole with adjustable traveller. **Genoa sheet tracks** with piston lead blocks.

Double sheet turning blocks with built-in jammer. Stainless steel swan neck electric cable gland. 2 x 4 and 6 sheave deck organizers for halyard returns.

5+2 clutches on coachroof. **2 x 40.2 ST halyard winches on coachroof. 2 x 48 ST Genoa sheet winches** on coamings close to helmsman. Spinlock clutch on toerail for Genoa furling line.

Sliding companionway hatch and washboards in Plexiglas with stops and lock.

GRP cover ahead of companionway with spray deflector.

COCKPIT

Teak trimmed seats, slightly curved GRP sole. Large side lockers with lids fitted with padlock hasps. GRP steering pedestal forming a footrest and instrument panel, with compass. Stainless steel arch above compass. Large leather rimmed steering wheel.

Rudder stock head under helmsman's seat for installing the emergency tiller. Engine control lever starboard and recessed engine control panel. Recessed instrument panel symmetrical to engine panel. **Stowage bins** built into engine and instrument panels. 2 winch pockets.

Transom opens in centre by tipping helmsman's seat giving access to the swim/boarding platform.

Large Propane locker in aft port seat. Locker for small equipment in aft starboard seat. **Life raft stowage in dedicated locker** under sole. Swim/boarding platform teak trimmed in central part. Cockpit shower in aft locker. Stainless steel bathing ladder with teak steps. Shore power socket in cockpit.

SAILS & RIGGING

Anodised aluminium mast with double swept backed spreaders, rigged 9/10, deck stepped. Anchor and steaming lights.

Possibility of rigging a removable inner forestay. Boom topping lift cleat. Anodised aluminium boom equipped with single line reefing system. **Rigid boom vang**, with tackle led back to cockpit. Genoa furling system. Discontinuous standing rigging in single strand stainless steel cable and chrome plated bronze turnbuckles including: forestay, backstay, cap shrouds, inter and lower shrouds. Backstay adjusted with stay tensionner. Running rigging in pre-stretched textile including: « low stretch » main and Genoa halyards, boom topping lift, main sheet on standing winch block with cleat on cockpit floor, Genoa sheets, adjustable mainsail track, boom vang, reefing lines and Genoa furling line. **Mainsail with logo in high tenacity cloth**, with two broad reef bands. **Navy blue mainsail cover. Special bi-radial roller furling Genoa** with anti-UV protection.

VENTILATION & LIGHTING

Very good ventilation ensured by 5 deck hatches and 6 opening port-lights. Lighting is completed by 2 fixed coachroof port-lights and 2 fixed hull port-lights. Electric lighting provided by numerous spotlights and reading lights.

INTERIOR

All joinery work in prime choice light Moabi mahogany, with fiddles and mouldings in solid wood. **Locker doors have ventilation louvers. The cabin doors have double anti-vibration bolts.** The soles are in varnished Moabi veneered marine plywood.

Cabin mattresses have removable covers in beige and navy blue fabric. The saloon cushions are in navy blue fabric.

The upper cabin and saloon linings are in Moabi wood.

COMPANIONWAY

Headroom: 1.95 m.

Removable companionway unit with wooden steps. Handrail. Removable engine wooden cover under companionway steps.

Battery switches under companionway.

FORWARD CABIN

Headroom: 1.92 m.

Large berth approx. 220 x 196 cm. 10 cm mattress in 2 parts (washable cover). Access to stowage lockers under berth.

Full length shelf with sea-fiddle over berth. Large hanging locker with shelves and seat forming a shoe locker.

Access to navigation instrument transducers. Water tank under berth.

FORWARD & AFT HEADS (DEPENDING ON VERSION)

Washbasin unit, with moulded washbasin and stainless steel handrail. Large mirror, chrome plated brass mixer tap with shower unit. Shower with direct drainage by electric pump. Manual marine toilet.

Closing upper lockers with ventilation louvers and **space for holding tanks**. Ventilation by deck hatch or opening portlight. **Hooks in aft head for hanging oilskins.**

SALOON

Large U-shaped settee to port. Settee to starboard. Saloon table with bar and folding leaf for easier circulation. Backrests and seats in foam with washable covers. Stowage under seats and behind backrests. Stowage lockers with doors and a bookshelf above each settee. Light and ventilation by deck hatch, 2 opening port-lights and 4 fixed port-lights and 8 spotlights. Solid wood mast pillar onto mast bulkhead.

GALLEY

L-shaped galley close to companionway. Synthetic stone work top with fiddle. Double stainless steel sink. Chrome plated brass mixer tap for pressurised water (hot/cold). Cooker with 2 burner stove/oven on gimbals. 12 V electric refrigerator with ice cube compartment. Stowage under sink with shelf and door. **Hinged door with garbage bin. Outboard lower cabinet with cutlery drawer and sliding vegetable baskets.** Upper cabinets with doors on hull side, one of which can house a microwave oven (option). Light and ventilation ensured by **opening port-light** and 2 spotlights over galley. **Crumb tray under sole.**

NAVIGATION

Large format chart table with hinged desk top, starboard to companionway. Seat with stowage underneath, vinyl covered curved cushion.

Outboard panel with switchboard and instrument panel. **Instrument console angled towards navigator.** Bookshelf under electrical switchboard. Stowage under chart table with drawer and door. Dome light and chart reading light.

AFT CABIN(S)

Headroom: 1.98 m.

Double berth approx. 195 x 141 cm. 10 cm thick foam mattress with washable cover. Large hanging locker with double door with shelf above. Seat forming shoe locker. Shelf with sea-fiddle over berth. Access behind engine, oddments tray on top.

Fuel tank under starboard berth. Water tank under port berth.

Lighting and ventilation by a deck hatch and an opening port-light and by 1 dome light and one reading spotlight.

SHOWER STALL (depending on version) Shower with direct drainage by electric pump. Shower with mixer tap and shower head mounted on track. Very large wet locker along hull side.

ENGINE

VOLVO 40 hp (29.1 kW). **Sail-drive** transmission. Heat exchanger, anti-siphon valve. Large capacity sea water filter.

Control panel close to helmsman, with hour meter and Plexiglas protection. 60 Ah alternator with battery isolator.

Fuel tank approx. 160 l, gauge on electrical switchboard. Fuel filter with water separator. Emergency fuel shut-off handle.

Engine room ventilation blower, and 2 ventilation hoses. Two-blade fixed propeller. Access to the engine from front and both sides. Independent engine bilge. Quality sound proofing high density foam.

PLUMBING

Polyethylene tanks for a total capacity of approx. 350 l with inspection plates and gauges on electrical switchboard.

Sump built into keel. Water heater 20 l running off engine transfer and 220 V. Electric bilge pump with strainer and filter and controls on switchboard. Manual bilge pump operated from cockpit. Drainage of shower water by pump(s) direct to the sea, easily accessible under the washbasin(s).

ELECTRICITY

12 V DC SYSTEM. 16 function backlit switchboard. 12V outlet at galley and switchboard.

1 x 100 Ah engine battery and 1 x 100 Ah service battery. Battery switch for each battery.

MISCELLANEOUS

2 winch handles with holder. Owner's briefcase with owner's manual. Grounded rigging system.

40th ANNIVERSARY PACK

Log /speed /sounder/wind indicator

Laminated floorboards

Separation in glass between galley and saloon

New cushions suede alike

Ergonomic seats

Supplementary design lighting

Battery charger

220V circuit

2 outlets in saloon and 1 per cabin

40th anniversary hull decoration

Extra service battery

Radio CD player with 2 interior loudspeakers

Dufour Crockery set

Deck hatches in polished aluminium

Book shelve in saloon

Electric windlass 1000 W

Sea water foot pump in galley

Maintenance and repair kit *



* for gelcoat and steal maintenance, winch grease, water disinfectant, spare hull decoration tape

PERFORMANCE PACK (see price list)







This document is in no way contractual. It is provided for information only and may be modified without notice.

The hull lines of this yacht meet all expectations: the vertical bow gives her a superb look.

Elegant in the way the bow splits the water surface, her refined hull lines, the wide beam especially in the aft sections, a subtle mixture of elements to meet the standards of blue water sailing even with only a small crew on board:

-  Increased form stability,
-  Gentle hull movements
-  Structural stiffness ideal for up wind sailing.

The cockpit of the Dufour 40 is a nice example for a model in this range:

-  Big steering wheel for a maximum of pleasure
-  Mainsail track at the bottom of the cockpit to facilitate manoeuvring on board
-  Genoa winches well aft in the cockpit and placed in the direct neighbourhood of the helmsman
-  Mainsail sheet adjustable either via a winch on the roof, or directly by the helmsman
-  Easy access to the bathing platform
-  Stowage space for the life raft integrated neatly in the cockpit.....Attention to detail !,

 On the inside plenty of light and ventilation is assured by numerous deck hatches and portlights. The galley in L-shape makes cooking onboard a unique experience: standing room 1.95 m , plenty of space to stow kitchen ware.

The chart table has solid fiddles, vast room for electronics and documents can be stowed away on several spots and a book shelf

No compromise was allowed in the volume of the berths: their length, room to stow away sailing gear in lockers and on shelves and enough room to move and breath.....

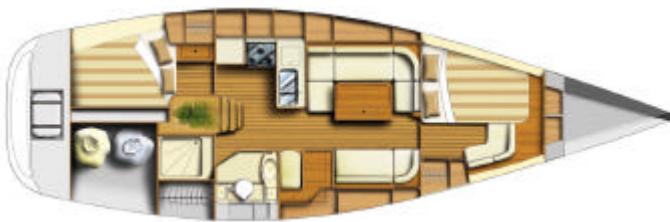

To enhance structural rigidity of the yachts, we use vacuum-bagged construction techniques for the hull.

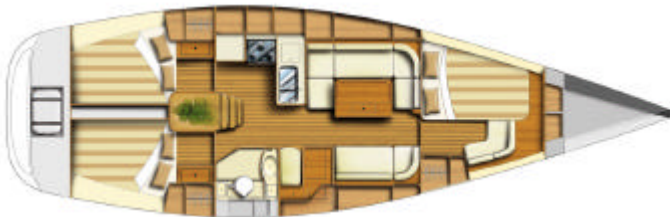



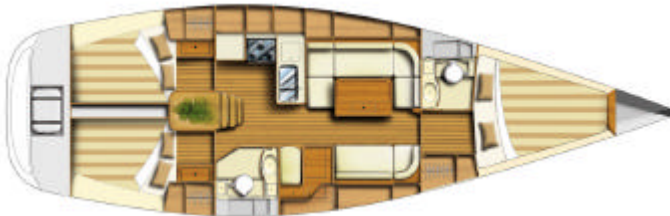

Structural grids and bulkheads are laminated to the outer and inner hull.



Decks are moulded by an injection process which allows significant weight saving in the upper structures and guarantees excellent finish.

High standards count for other materials too:

-  We use lead for deep keel yachts
-  rudders with closed cell epoxy foam
-  stainless steel solid rudder stocks for maximum solidity
-  self aligning bearings for sturdiness and less friction.

